

# THERMACUT® REPLACEMENT PARTS SUITABLE FOR Thermal Dynamics® PCH/M-6B

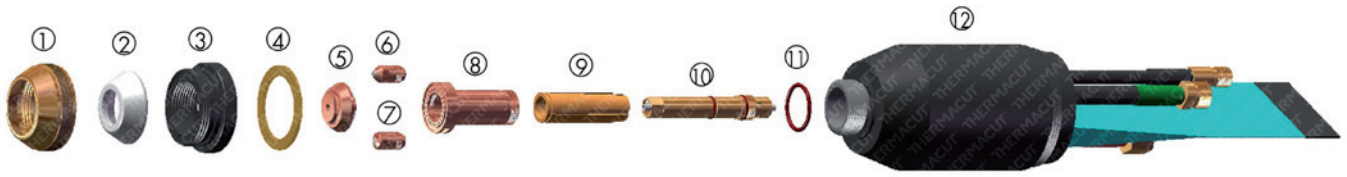

Item	Part No.	Ref. No.	Description	Std. Pkg.	Item	Part No.	Ref. No.	Description	Std. Pkg.
1.	T-0233	8-6515	End Cap	1	12.	T-0217	8-6577	6B Machine Torch	1
2.	T-0232	8-6514	Insulator, End Piece	5		T-1423	8-6583	6B Hand Torch 70°	1
3.	T-0231	8-6581	Outer Insulator	1		T-0216	8-6584	6B Hand Torch 90°	1
4.	T-0230	8-6512	Gasket, Outer Insulator	5	NS	T-0159	8-5005	Positioning Tube	1
5.	T-0229	8-6572	Tip .125 400A	5	NS	T-0236	8-6517 OEM	Liner/Tip Wrench	1
	T-0228	8-6582	Tip .113 300A	5	NS	T-0161	8-4204	Bushing	1
	T-0227	8-6575	Tip .093 200A	5	NS	KT-1337	2-2747	PCH-6B 70° Torch with Leads 15.2m (50'), PAK®45	1
	T-0226	8-6648	Tip .076 150A	5	NS	KT-1431	2-2789	PCH-6B 70° Torch with Leads 15.2m (50'), PAK®44	1
	T-0225	8-6580	Tip .067 100A	5	NS	KT-1215	2-2790	PCH-6B® 90° Torch with Leads 7.6m (25')	1
6.	T-0224	8-6586	Electrode, N <sub>2</sub> , Metal Seat, L-Amp	10	NS	T-13077	2-2791	PCH-6B® 90° Torch with Leads 15.2m (50')	1
7.	T-0223	8-6578	Electrode, N <sub>2</sub> , Gen. Purpose	10	NS	KT-1323	4-2725	PCH-6B® Cable Leads 7.6m (25')	1
8.	T-0222	8-6571	Liner Assy	1	NS	KT-1324	2-2792	PCM-6B® 180° Torch with Leads 7.6m (25')	1
9.	T-0221	8-6587	Gas Distributor, 6B, 4 Holes, Rev. Swirl	1	NS	KT-1188	4-2726	PCH-6B® Cable Leads 15.2m (50')	1
	T-0220	8-6569	Gas Distributor, 6B, 4 Holes	1	NS	KT-1198	2-2749	PCM-6B® 180° Torch with Leads 15.2m (50')	1
10.	T-0219	8-6615	Electrode Holder	1	NS	KT-1443	9-2866	Plasma Hose 7.6m (25')	1
11.	T-0108	8-0531	O-Ring	1	NS	KT-1444	9-2950	Power Hose 7.6m (25')	1

NS NOT SHOWN IN THE PICTURE

Last update of this page: 28/02/2019. See Revision history for details.

**THERMACUT®**  
THE CUTTING COMPANY

WWW.THERMACUT.CZ  
TEL.: +420 556 423 418  
SALES@THERMACUT.CZ

WWW.THERMACUT.DE  
TEL.: +49 (0) 27 39 40 33 0  
INFO@THERMACUT.DE

WWW.THERMACUT.COM  
TEL.: 1-603-542-6715  
CUSTOMERSERVICE@THERMACUT.COM

THERMACUT®, THE CUTTING COMPANY®, FHT-EX®, EX-TRAFIRE®, EX-TRACK®, EX-TRABEAM® AND EX-TRAFAME® ARE REGISTERED TRADEMARKS OF THERMACUT, K.S. AND MAY BE REGISTERED IN CZECH REPUBLIC AND/OR OTHER COUNTRIES. ALL OTHER TRADEMARKS ARE PROPERTIES OF THEIR RESPECTIVE OWNERS. THERMACUT IS NO WAY AFFILIATED WITH Thermal Dynamics®. MOST THERMACUT PARTS ARE MADE FOR OR BY AN IBC COMPANY. PARTS INDICATED WITH A OEM ARE ORIGINAL PARTS MANUFACTURED BY THE ABOVE NAMED MANUFACTURER AND ARE BEING RESOLD BY THERMACUT. THERMACUT RESERVES THE RIGHT TO SUBSTITUTE OEM PARTS IN PLACE OF THERMACUT PARTS. VALID FROM NOVEMBER 2020 • PREVIOUS VERSION IS NO LONGER VALID. • © COPYRIGHT 2020 BY THERMACUT® CZECH REPUBLIC. ALL RIGHTS RESERVED.